



## Installation instruction of 4.3/10 type male connector for 1/4" superflexible cable

43M-SCF14-CP01

**ITEM: 2161235.1**

Please read the instructions carefully before assembly.

Tools and Material:

Trimming tool, compression gun, power drill, coring bit, cable cutter, foam remover.

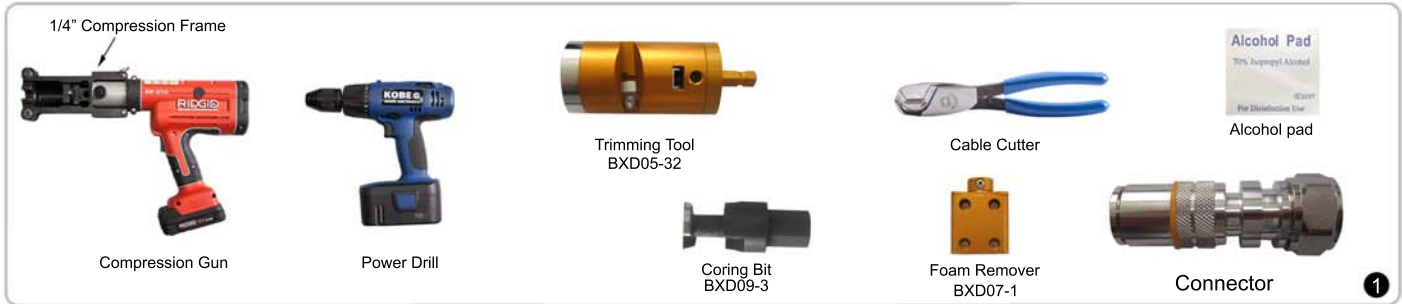

Assembly tools (required).

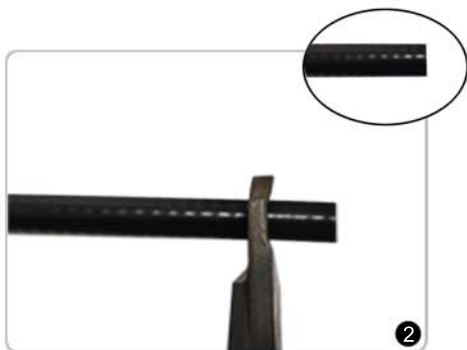

Straighten cable.  
Cut off the cable head.



Attach the trimming tool to power drill.



Insert the cable into the trimming tool. Select the low speed on the drill or 400~600RPM on a variable speed drill. Trim the cable until no further debris generated.

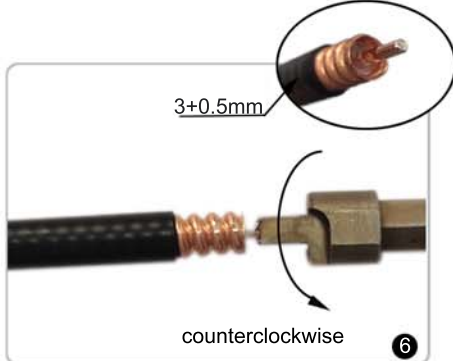

Use the coring bit counterclockwise to remove dielectric. The depth showed be 3+0.5mm .

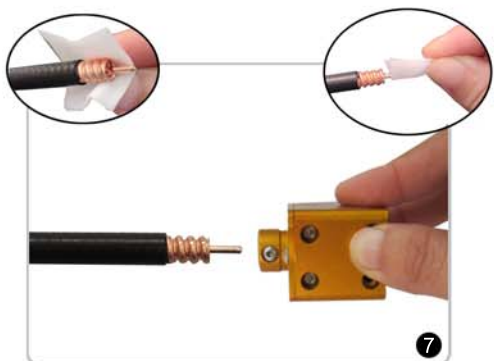

Use foam remover to remove any dielectric residue from the inner conductor. Clean the inner and outer conductor with alcohol pad.

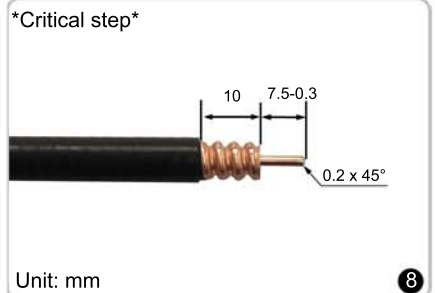

Unit: mm



Align outer conductor as shown with groove on body. Mark cable jacket in line with end of connector.

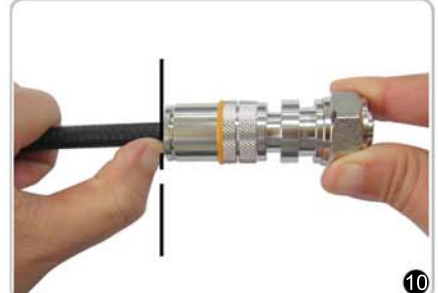

Screw the connector onto the cable until it reaches the marked line. Over tighten is forbidden.



Installation instruction of 4.3/10 type male connector for 1/4" superflexible cable

43M-SCF14-CP01

**ITEM: 2161235.1**



11 Make sure the connector and cable both lay flat in the compression frame.

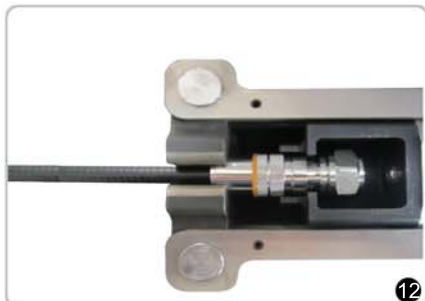

12 Press the trigger on the compression gun until it cycles and you hear a "pop". Do not pull or push on compression gun during compression.



13 Finished.

